

xiaomi

Vacuum Cleaner G11 User Manual



Safety Instructions

This product is for household use only. Read this manual carefully before use, and retain it for future reference.

- This appliance can be used by children aged from 8 years and above and persons with reduced physical, sensory or mental capabilities or lack of experience and knowledge if they have been given supervision or instruction concerning use of the appliance in a safe way and understand the hazards involved. Children shall not play with the appliance. Cleaning and user maintenance shall not be made by children without supervision.
- The vacuum cleaner is not a toy. Children may not play with or operate this product.
- Only use the vacuum cleaner on dry indoor surfaces. Do not install, charge, or use this product outdoors, such as in bathrooms, or near a pool.
- Do not touch the plug or any part of the vacuum cleaner with wet hands.
- Only use the BLJ24WD260090P-V power supply provided with the appliance.
- Only use the MJWXCQ05XYHW-DC battery pack provided with the appliance.
- If the power supply or battery becomes damaged, it must be replaced with a genuine component purchased from the manufacturer or after-sales service department.
- To reduce the risk of fire, explosion, or personal injury, check to make sure the lithium-ion battery and power supply are undamaged before use. Do not use the vacuum cleaner if either the battery or power supply is damaged.
- The electric tangle-free brush bar, electric mite brush, battery, extension rod, and vacuum cleaner are electrically conductive and should not be immersed in water or other liquids. Make sure all parts are thoroughly dry after cleaning.
- To prevent injury caused by moving parts, turn off the vacuum cleaner before cleaning the electric tangle-free brush bar and the electric mite brush. The electric tangle-free brush bar, electric mite brush, dust compartment, and filter must all be properly installed before using the vacuum cleaner.
- Periodically examine the extension rod and do not use it if it is damaged.
- Neither use the vacuum cleaner to pick up flammable or explosive liquids such as gasoline, nor other liquids such as water or toxic liquids like bleach, ammonia, and drain cleaners.
- Do not use the vacuum cleaner to pick up drywall particles, ashes like fireplace ash, or smoking or burning materials such as coal, cigarette butts or matches.
- Do not use the vacuum cleaner to pick up sharp or hard objects, such as glass, nails, screws, or coins, which may damage the product.
- Keep hair, loose clothing, fingers, and other parts of the body away from the vacuum cleaner's openings and moving parts. Do not point the suction opening, extension rod, or other accessories at your eyes or ears or put them in your mouth.
- Do not put any object into the vacuum cleaner's openings, nor use the vacuum cleaner with any opening blocked. Keep free of dust, lint, hair, or other items which may reduce the suction power of the vacuum cleaner.
- Do not rest the vacuum cleaner against a chair, table, or other unstable surfaces, as this may cause damage to the product or personal injury. If the vacuum cleaner malfunctions because of being knocked over or damaged, please contact the authorized service department. Never attempt to disassemble the vacuum cleaner on your own.
- All instructions in the user manual for recharging the product must be strictly followed. Failure to properly charge the vacuum cleaner within the specified temperature range could damage the battery.
- Do not charge or store the vacuum cleaner near heat sources or in humid areas, such as by a radiator or in a kitchen or bathroom.
- Only use accessories and replacement parts that are approved by Xiaomi.

- Do not use the electric tangle-free brush bar or electric mite brush on power cords to avoid potential danger.
- When the battery is not in use, keep it away from all metal objects, such as paper clips, coins, keys, nails, or screws. Shorting the battery terminals together increases the risk of fire or burns.
- Under abusive conditions, liquid may be ejected from the battery. Avoid contact with liquid, as it may cause irritation or burns. If contact occurs, flush with water. If liquid contacts eyes, seek medical help.
- DO NOT expose the battery and appliance to fire as it may cause explosion.
- DO NOT expose or submerge the battery and appliance in any water, salt water, or other liquids.
- The lithium-ion battery pack contains substances that are hazardous to the environment. Before disposing of the vacuum cleaner, please first remove the battery pack, then discard, or recycle it in accordance with local laws and regulations of the country or region it is used in.
- In the event of a battery leak, avoid contact with the liquid and dispose of the battery at a government-approved recycling facility. In case of contact with eyes, rinse with plenty of water and seek medical attention immediately.
- Make sure the vacuum cleaner is unplugged when not used for extended periods as well as prior to performing any maintenance or repairs.
- Please be extra careful when using the vacuum cleaner to clean stairs.
- Fire Hazard Warning: Do not apply any type of fragrance to the vacuum cleaner's filter. These types of products are known to contain flammable chemicals which may cause the vacuum cleaner to catch fire.
- For optimal battery performance and to prolong the battery service life, it is recommended to use the Eco and the Auto suction levels.
- You may not be able to use the Turbo suction level when the temperature is low or the battery level is low, which is normal. This is to protect the battery and to maximize the battery performance. You can choose to use the Eco and the Auto suction levels instead.
- Do not use the vacuum cleaner at an ambient temperature below 7°C or above 35°C. If the environment is extremely hot or cold, the aging of the battery will accelerate and the vacuum cleaner may not be able to function properly.
- Please strictly follow the instructions in this user manual when using the vacuum cleaner. Users are responsible for any loss or damage that may arise from improper use of the vacuum cleaner.

Regulatory Compliance Information

EU Declaration of Conformity



- We, Beijing Shunzao Technology Co., Ltd., hereby, declare that this equipment is in compliance with the applicable Directives and European Norms, and amendments. The full text of the EU declaration of conformity is available at the following internet address:
<http://www.mi.com/global/service/support/declaration.html>
- For detailed e-manual, please go to www.mi.com/global/service/userguide

WEEE Disposal and Recycling Information



- All products bearing this symbol are waste electrical and electronic equipment (WEEE as in directive 2012/19/EU) which should not be mixed with unsorted household waste. Instead, you should protect human health and the environment by handing over your waste equipment to a designated collection point for the recycling of waste electrical and electronic equipment, appointed by the government or local authorities. Correct disposal and recycling will help prevent potential negative consequences to the environment and human health. Please contact the installer or local authorities for more information about the location as well as terms and conditions of such collection points.

Product Overview

Accessories List



Extension Rod

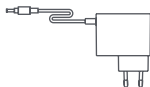

Power Supply



Brush Nozzle



Crevice Nozzle

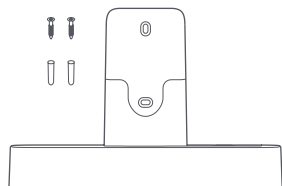

2-in-1 Charging & Storage Mount
(includes screw × 2, wall plug × 2)

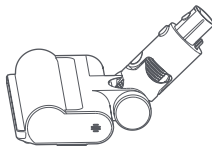

Electric Tangle-free Brush Bar

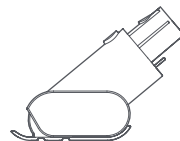

Electric Mite Brush

Note: Illustrations of product, accessories, and user interface in the user manual are for reference purposes only. Actual product and functions may vary due to product enhancements.

Vacuum Cleaner

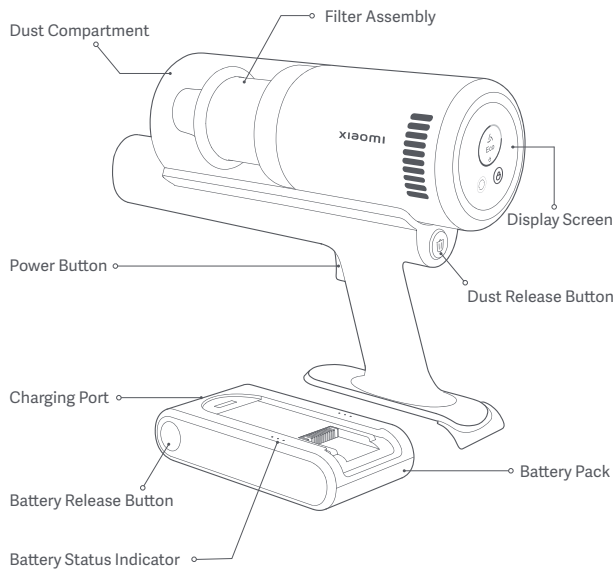

Display and Buttons

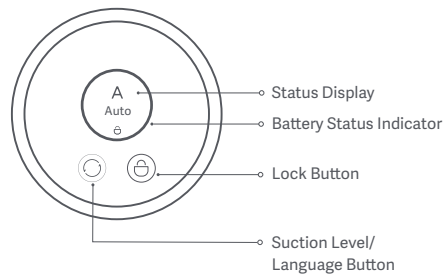

Note: When the vacuum cleaner runs at the Turbo suction level using the crevice nozzle or the brush nozzle, the battery level indicator is in a breathing green state. This is normal.

How to Install

Installing the Battery

Slide the vacuum cleaner along the battery track until it clicks into place.

Note: After installing the battery, press the power button to turn on the vacuum cleaner.

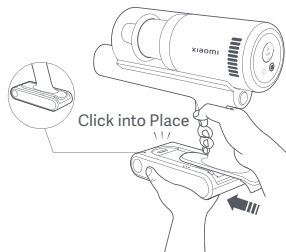

Removing the Battery

Hold the vacuum cleaner in one hand and grasp the battery in the other hand, then press the battery release button and pull the vacuum cleaner in the direction shown to separate it from the battery.

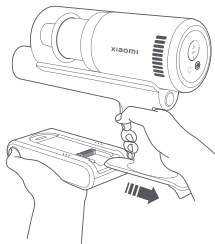

Installing the 2-in-1 Charging & Storage Mount

- The 2-in-1 charging & storage mount should be installed in a cool and dry place with an electrical outlet nearby. Prior to installing, ensure that there are not any wires or pipes in the wall directly behind where the mount will be installed.
- The bottom of the 2-in-1 charging & storage mount should be at least 115 cm from the ground.
- Select a suitable installation place and mark the positions of the mounting holes on the wall.
- Use a power drill with an 8 mm drill bit to drill a hole approximately 40 mm deep in each marked position, then insert a wall plug into each hole.
- Align the mounting holes on the 2-in-1 charging & storage mount to the holes on the wall, then attach the mount to the wall using the included screws.

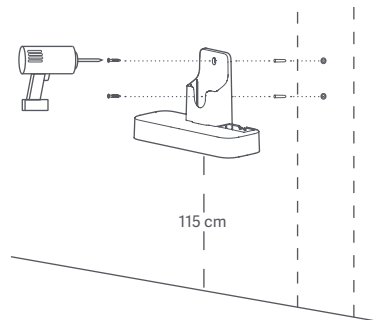

Installing the Accessories onto the Vacuum Cleaner

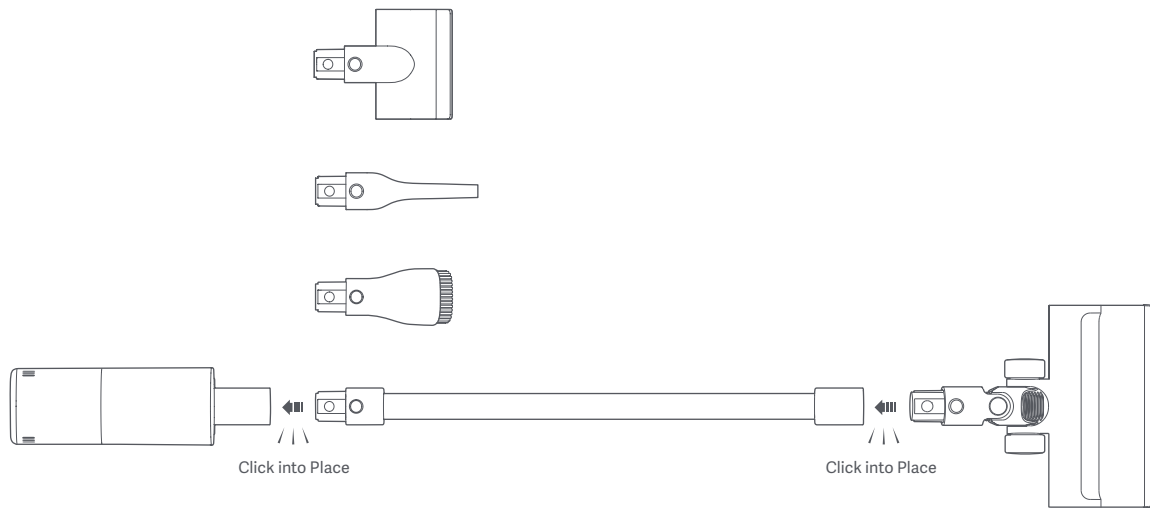

Charging

Charging the Vacuum Cleaner with the Power Supply

The battery can be charged while installed on the vacuum cleaner, or removed and charged separately.

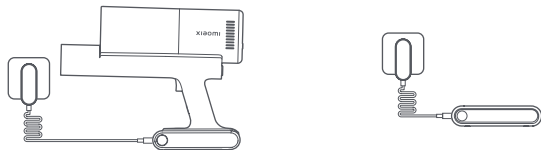

Charging on the 2-in-1 Charging & Storage Mount

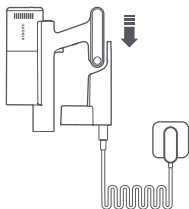

Notes:

- Fully charge the vacuum cleaner before using it for the first time. This will take about 3 hours.
- Once the vacuum cleaner is fully charged, the indicator will turn off after 1 minute, and the vacuum cleaner will then enter the energy-saving mode.
- Vacuuming at the highest suction level for a prolonged period will cause the battery to heat up, which may increase the charging time. Before charging the vacuum cleaner, it is better to cool it down for 30 minutes.

Battery Status Indicator

● Off ☼ Blinking ○ On

During Use

● ● ○ Low battery ○ ○ ○ Nearly full
● ○ ○ Half battery

Battery Status Indicator

☼ ☼ ☼ Charging (low battery level) ☼ ○ ○ Charging (high battery level)
☼ ☼ ○ Charging (medium battery level) ○ ○ ○ Fully charged

Display Screen

The number on the display screen represents the current battery level in a percentage during charging. When the number turns into 100, the battery is fully charged.

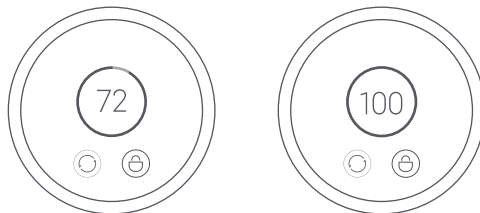

How to Use

Electric Tangle-free Brush Bar

For cleaning marble, wood, and short pile carpeted floors.

Note:

It is normal for the roller brush to accumulate small amounts of hair over time. There is a motor contained in the electric tangle-free brush bar, which can help to cut hairs tangled on the roller brush. The motor runs periodically and after it runs continuously for a period of time, the tangled hair will be cut away automatically.

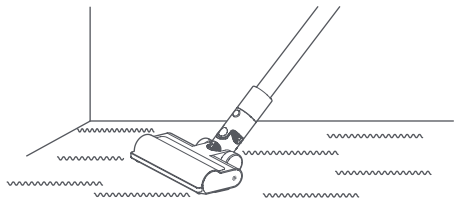

Electric Mite Brush

For cleaning dust and mites on most fabric surfaces including mattresses, fabric sofas, and blankets.

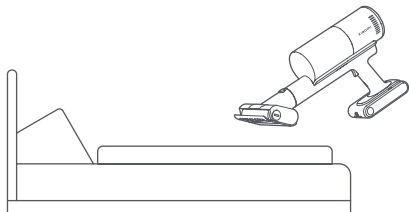

Crevice Nozzle

For cleaning narrow and hard-to-reach spaces like corners of doors and windows, sliding door tracks, wall corners and crevices, and vehicle interiors.

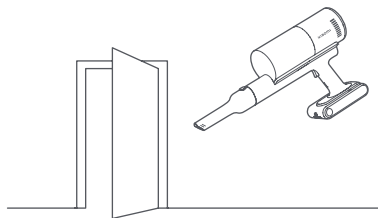

Brush Nozzle

For vacuuming dust on curtains, keyboards, ceilings, vehicle interiors, coffee tables, etc.

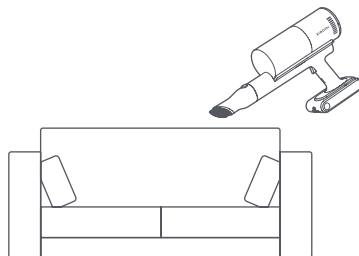

Care & Maintenance

Display and Buttons Instructions

When using the electric tangle-free brush bar, electric mite brush, crevice nozzle, or brush nozzle, the vacuum cleaner uses the Auto Mode as the default, and the Auto Mode will show on the display.

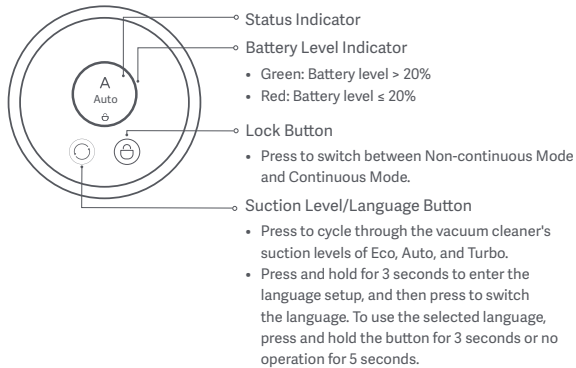

Working Modes

Non-continuous Mode

Hold down the power button to start the vacuum cleaner, then release to stop it.

Continuous Mode

Press the button  to switch to Continuous Mode. Press the power button of the vacuum cleaner, it will work continuously; press the power button again, it will stop working.

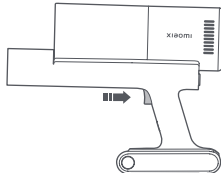

Precautions:

- Always use genuine parts to ensure normal operation and to keep your warranty valid.
- If any rotating part becomes stuck, the vacuum cleaner may shut off automatically. Remove any trapped foreign objects, then resume use.
- Before cleaning, remove the brush head from the vacuum cleaner to prevent accidentally turning on the vacuum cleaner, which can cause injury.
- If the vacuum cleaner will not be used for an extended period, fully charge it and disconnect it from the power then store it in a cool, low-humidity environment away from direct sunlight.
- To avoid over-discharging the battery, recharge the vacuum cleaner at least once every three months.

Cleaning the Vacuum Cleaner

Wipe the vacuum cleaner with a soft, dry cloth.

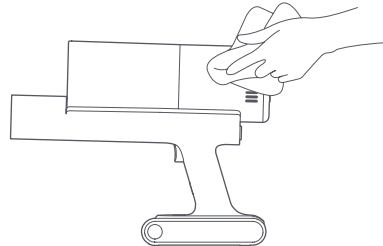

Cleaning the Dust Compartment

Before cleaning the dust compartment, disconnect the power supply and remove the extension rod. The vacuum cleaner's cleaning ability will be reduced if the dust compartment is filled to the "MAX" mark. To regain performance, empty the dust compartment.

- Empty the dust compartment: Hold the dust compartment over a trash bin, then press the dust release button to empty out the dust.

Note: There is a rubber baffle inside the dust compartment, please do not remove it.

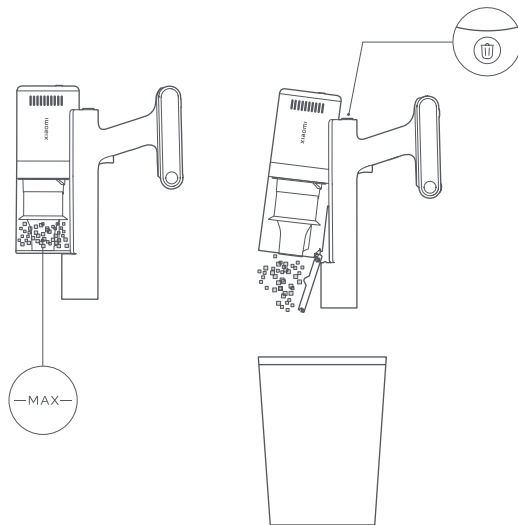

Cleaning the Dust Compartment and Filter Assembly

1. Press the dust release button to open the dust compartment cover, then rotate and pull out the dust compartment in the direction shown and remove the filter assembly.

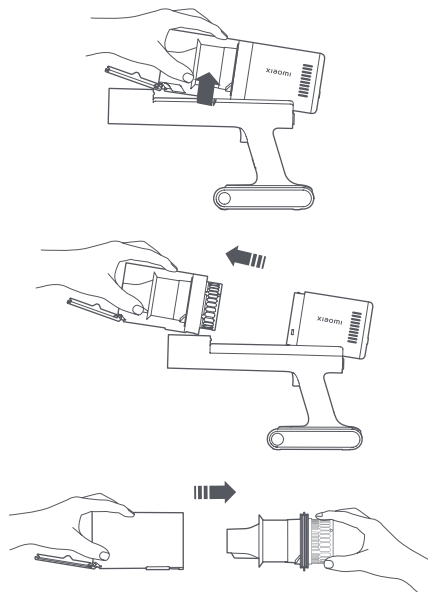

- Untwist and remove the filter from the pre-filter, then pull out the sponge filter from the filter.

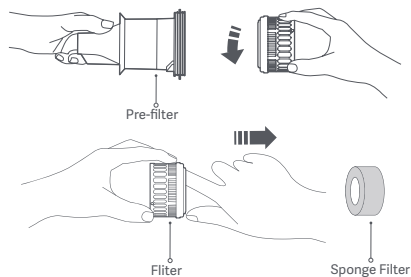

- Rinse the dust compartment, pre-filter, filter, and sponge filter under running tap water until clean, then set aside all parts to fully dry for at least 24 hours.

Notes:

- Clean the filter, then rinse it out and lightly tap on the edge of the filter to remove dust and debris.
- Do not touch the surface of the filter or sponge filter with hands, brush, or sharp objects to avoid damaging the filter.
- Do not immerse the filter in water.
- If the suction power is still significantly reduced after the filter assembly is cleaned, you can try to replace with a new genuine filter.

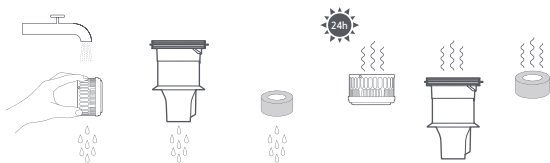

Cleaning the Dust Sensor

Remove the dust compartment and filter assembly, then clean the sensor area with a soft dry cloth.

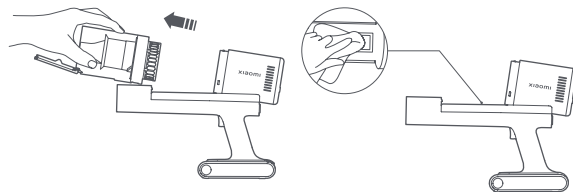

Cleaning the Electric Tangle-free Brush Bar

- Place the brush head upside down on a flat surface so the brush bar faces upward. Push the brush release button in the direction indicated by the arrow until the cover of the brush head pops open, then remove the brush bar by lifting it in the direction indicated.

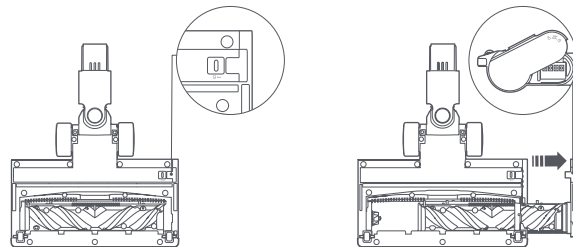

2. Wipe away excess dust and debris from the tangle-free brush bar, suction opening, and transparent plastic cover using a dry cloth or paper towel.

Note: The tangle-free brush bar contains an electric motor. Do not clean it with water.

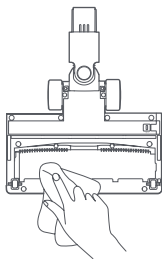

3. Reinsert the roller brush in the direction shown and firmly press the end cap until it clicks into place.

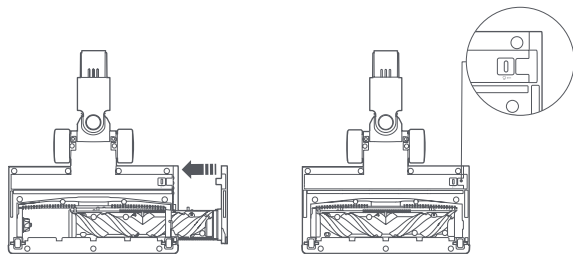

Cleaning the Electric Mite Brush

1. Use a coin to turn the lock counterclockwise until you hear a click.

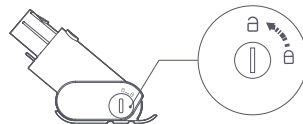

2. Remove the roller brush from the electric mite brush, then rinse and clean it.

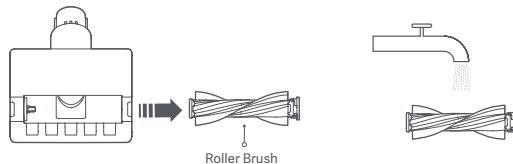

3. Allow the roller brush to dry thoroughly by standing it upright in a well-ventilated area for at least 24 hours. Once the roller brush is dry, reinstall it by following the disassembly steps in reverse.

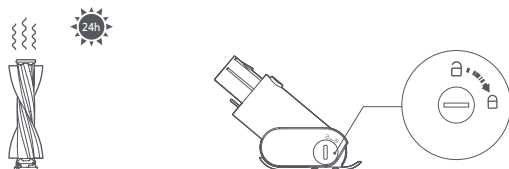







FAQ

Issue	Possible Cause	Solution
The vacuum cleaner does not work.	Battery is depleted.	Charge the vacuum cleaner before use.
	Airway is blocked or filter is clogged.	Clear any blockages from the suction opening or airway passage and clean the filter.
	Filter is not installed or dust compartment is not securely closed.	Ensure the filter and dust compartment are installed correctly.
	Battery has an overheating protection.	Wait until the battery temperature returns to normal, then resume use.
The suction power reduces.	Dust compartment is full or filter is clogged.	Empty the dust compartment and clean the filter.
	Brush head is clogged.	Clear any blockages in the attachment.
Poor battery life.	Battery is not fully charged.	Charge the vacuum cleaner before use.
	Dust compartment is full or filter is clogged.	Empty the dust compartment and clean the filter.
	Brush attachment or brush head is clogged.	Clear any blockages in the attachment.
The vacuum cleaner is unable to charge.	The power supply being used is not genuine.	Only use the genuine power supply to charge the vacuum cleaner.
The battery charges slowly.	The battery temperature is too low or too high.	Wait until the battery temperature normalizes, then resume use.

Troubleshooting

If the vacuum cleaner is not working properly, the display will show an error message. Please refer to the troubleshooting table below to find your solution based on the error message.

Error Icon	Error Message	Solution
	Airway Blocked	Clear any blockages from the dust compartment, pre-filter, filter, extension rod, brush bar, and nozzle.
	Roller Brush Stuck	Remove any debris or objects clogged or tangled on the roller brush.
	Low Battery	Recharge soon.
	Battery Depleted	Recharge soon.
	Battery Overheated	Wait until the battery temperature normalizes, then resume use.
	Clean the Sensor	Wipe away dust from the sensor using a dry cloth or paper towel.
	Filter/Dust Compartment Error	Filter is not installed correctly, or dust compartment is not closed securely or installed. Please install them properly.
	Power Supply Error	Only use the genuine power supply to charge the vacuum cleaner.
	Error Code	Please contact after-sales service to arrange maintenance.

Specifications

Xiaomi Vacuum Cleaner G11					
Name	Cordless Vacuum Cleaner		Model	MJWXCQ05XYHW	
Rated Voltage	22.2 V \approx		Rated Power	500 W	
Charging Votage	26.0 V \approx		Net Weight	4.15 kg	

Electric Tangle-free Brush Bar			Electric Mite Brush		
Model	MJWXCQ05XYHW-DS		Model	MJWXCQ05XYHW-CM	
Rated Power	90 W		Rated Power	10 W	
Rated Voltage	22.2 V \approx		Rated Voltage	22.2 V \approx	

Battery Pack		Power Supply			
Model	MJWXCQ05XYHW-DC	Manufacturer	Zhongshan Baolijin Electronic Co., Ltd.	Average Active Efficiency	87.0%
Rated Capacity	3050 mAh	Model	BLJ24WD260090P-V	Efficiency at Low Load (10%)	79.2%
Energy	67.71 Wh	Input	100–240 V~ 50/60 Hz 0.8 A	No-load Power Consumption	0.06 W
Nominal Voltage	22.2 V \approx	Output	26.0 V \approx 0.9 A 23.4 W		

WARRANTY NOTICE

THIS WARRANTY GIVES YOU SPECIFIC RIGHTS, AND YOU MAY HAVE OTHER RIGHTS CONVEYED BY LAWS OF YOUR COUNTRY, PROVINCE OR STATE. INDEED, IN SOME COUNTRIES, PROVINCES OR STATES, CONSUMER LAW MAY IMPOSE A MINIMUM WARRANTY PERIOD. OTHER THAN AS PERMITTED BY LAW, XIAOMI DOES NOT EXCLUDE, LIMIT OR SUSPEND OTHER RIGHTS YOU MAY HAVE. FOR A FULL UNDERSTANDING OF YOUR RIGHTS WE INVITE YOU TO CONSULT THE LAWS OF YOUR COUNTRY, PROVINCE OR STATE.

1.LIMITED PRODUCT WARRANTY

XIAOMI warrants that the Products are free from defects in materials and workmanship under normal use and use in accordance with the respective Product user manual, during the Warranty Period.

The duration and conditions related to the legal warranties are provided by respective local laws. For more information about the consumer warranty benefits, please refer to Xiaomi's official website <https://www.mi.com/en/service/warranty/>.

Xiaomi warrants to the original purchaser that its Xiaomi Product will be free from defects in materials and workmanship under normal use in the period mentioned above.

Xiaomi does not guarantee that the operation of the Product will be uninterrupted or error free.

Xiaomi is not liable for damages arising from non-compliance with the instructions related to the use of the Product.

2.REMEDIES

If a hardware defect is found and a valid claim is received by Xiaomi within the Warranty Period, Xiaomi will either (1) repair the product at no charge, (2) replace the product, or (3) refund the Product, excluding potential shipping costs.

3.HOW TO OBTAIN WARRANTY SERVICE

To obtain warranty service, you must deliver the Product, in its original packaging or similar packaging providing an equal degree of Product protection, to the address specified by Xiaomi. Except to the extent prohibited by applicable law, Xiaomi may require you to present proofs or proof of purchase and / or comply with registration requirements before receiving warranty service.

4.EXCLUSIONS AND LIMITATIONS

Unless otherwise stipulated by Xiaomi, this Limited Warranty applies only to the Product manufactured by or for Xiaomi and identifiable by the trademarks, trade name or "Xiaomi" or "Mi" logo.

The Limited Warranty does not apply to any (a) Damage due to acts of nature or God, for example, lightning strikes, tornadoes, flood, fire, earthquake or other external causes; (b) Negligence; (c) Commercial use; (d) Alterations or modifications to any part of the Product; (e) Damage caused by use with non-Xiaomi products; (f) Damage caused by accident, abuse or misuse; (g) Damage caused by operating the Product outside the permitted or intended uses described by Xiaomi or with improper voltage or power supply; or (h) Damage caused by service (including upgrades and expansions) performed by anyone who is not a representative of Xiaomi.

It is your responsibility to backup any data, software, or other materials you may have stored or preserved on the product. It is likely that the data, software or other materials in the equipment will be lost or reformatted during the service process, Xiaomi is not responsible for such damage or loss.

No Xiaomi reseller, agent, or employee is authorized to make any modification, extension, or addition to this Limited Warranty. If any term is held to be illegal or unenforceable, the legality or enforceability of the remaining terms shall not be affected or impaired.

Except as prohibited by laws or otherwise promised by Xiaomi, the after-sales services shall be limited to the country or region of the original purchase.

Products which were not duly imported and/or were not duly manufactured by Xiaomi and/or were not duly acquired from Xiaomi or a Xiaomi's official seller are not covered by the present warranties. As per applicable law you may benefit from warranties from the non-official retailer who sold the product. Therefore, Xiaomi invites you to contact the retailer from whom you purchased the product.

The present warranties do not apply in Hong Kong and Taiwan.

5.IMPLIED WARRANTIES

Except to the extent prohibited by applicable law, all implied warranties (including warranties of merchantability and fitness for a particular purpose) will have a limited duration up to a maximum duration of this limited warranty. Some jurisdictions do not allow limitations on the duration of an implied warranty, so the above limitation will not be applied in these cases.

6.DAMAGE LIMITATION

Except to the extent prohibited by applicable law, Xiaomi shall not be liable for any damages caused by accidents, indirect, special or consequential damages, including but not limited to loss of profits, revenue or data, damages resulting from any breach of express or implied warranty or condition, or under any other legal theory, even if Xiaomi has been informed of the possibility of such damages. Some jurisdictions do not allow the exclusion or limitation of special, indirect, or consequential damages, so the above limitation or exclusion may not apply to you.

7.XIAOMI CONTACTS

For customers, please visit the website: <https://www.mi.com/en/service/warranty/>

The contact person for the after-sale service may be any person in Xiaomi's authorized service network, Xiaomi's authorized distributors or the final vendor who sold the products to you. If in doubt please contact the relevant person as Xiaomi may identify.

Manufactured for: Xiaomi Communications Co., Ltd.

Manufactured by: Beijing Shunzao Technology Co., Ltd.

(a Mi Ecosystem company)

Address: 101, 1st floor, Building1, No.16, Anningzhuang East Road, Haidian District, 100089 Beijing, PEOPLE' S REPUBLIC OF CHINA For further information, please go to www.mi.com

Importer:

Beryko s.r.o.

Pod Vinicemi 931/2, 301 00 Plzeň

www.beryko.cz