

Mi Induction Heating Rice Cooker

Please read this manual carefully before using, and keep it for future reference.



Table of Contents

IHFB01CM_V0.3

Please read this manual carefully and follow the operating instructions.

The product is for household use only.

Please pay special attention to important safety instructions.

01. Health through innovation	02
02. Important safety instructions	02
03. Special Cord Set Instructions	04
04. Before first use	05
05. Precaution For The Cooker	05
06. Before Maintenance	05
07. Power Plug, Power Cord	05
08. During Usage	06
09. Product Overview	08
10. Quick Start Guide	09
11. Download the App	10
12. How to Set the Time	10
13. Control Panel Description	10
14. How to Cook Rice	11
Rice, Quick Rice	11
Congee, Keep Warm	11
Favorite, Timer	11
15. Cleaning	12
Remove & Mount	12
16. Troubleshooting	13
17. Fault Code	14
18. Specifications	16
19. DOC	16

HEALTH THROUGH INNOVATION

Congratulations on the purchase of this high quality product. In order to cook rice or steam vegetables on a rice cooker, one must follow different principles than those of conventional rice cooking. The rice or vegetables are specially prepared to get an intense flavor. The steaming function preserves the vitamins in fishes and vegetables, preserving their natural flavor and nutritional value and preventing the generation of harmful compounds. Use fresh ingredients whenever possible to get a healthy and balanced meal.

The electronic control system looks after the hard work allowing you to enjoy the benefits of good food with less effort!

Used and cared for in line with the guidance provided within this instruction manual it should provide you with many years of trouble free service.

Dear customer!

Your new product helps you prepare delicious meals in no time.

The product is easy to handle and simple to clean, due to its inner pot with non-stick coating.

This item has integrated safety devices. You should nevertheless read the safety instructions carefully and only use the item as described in this manual, in order to avoid incidental injuries or damages.

Keep this manual for further use. In case the item is passed on, this manual has to be passed on as well.



This sign warns you of the risk of injuries.



This sign warns you of the risk of injuries due to electricity.



This sign warns you of the risk of burns or scalding.



This sign marks additional information.

Important safety instructions

INTENDED USE



It is exclusively designed for the private household and it is not intended for commercial purposes.

The manufacturer does not accept any liability in the case of improper use caused by failure to observe this instruction manual.

In order to avoid hazards, only customer service is authorized to carry out repairs at the item.

The important precautions described within this section must be followed carefully to prevent the possibility of fire, electrical shock, personal injuries and/or property damage:



1. Read all instructions.
2. Do not touch HOT surfaces. Use handles or knobs.
3. To protect against fire, electrical shock, and personal injury, do not immerse cord, plugs, or appliance in water or other liquid.
4. Close supervision is necessary when the appliance is used by or near children.
5. Unplug unit from outlet when not in use and before cleaning. Allow to cool before attaching or removing parts, and before cleaning the appliance.
6. Do not operate any appliance with a damaged cord or plug after the appliance malfunctions or has been damaged in any manner. Return appliance to an authorized service facility for examination, repair or adjustment.
7. To protect against risk of electrical shock, do not force any foreign objects, such as pins and wires, into any openings.
8. The use of accessory attachments not recommended by the appliance manufacturer may result in fire, electric shock or personal injury.
9. Do not use outdoors.
10. Do not let cord hang over edge of table or counter, or touch hot surfaces.
11. Do not place the appliance on or near a hot gas or electric burner, or in a heated oven.
12. Extreme caution must be used when moving an appliance containing hot oil or other liquids.
13. Do not clean the appliance with cleansers, steel wool pads, or other abrasive material.
14. Always attach plug to appliance first, then plug cord into the wall outlet. To disconnect, turn the switch to its "OFF" position then remove the plug from wall outlet.
15. Do not use appliance for other than intended use. This product is designed for household use only.
16. Use only the appropriate Volt AC electrical current.
17. Always keep the power supply plug clean.
18. Plug the appliance into a single electrical outlet only.
19. Make sure that the power supply plug is firmly inserted all the way into the electrical outlet.
20. Do not attempt to plug in or unplug with wet hands.
21. Do not touch the steam vent.
22. Do not handle the power supply cord in a rough manner.
23. Grasp only the plug when unplugging the power supply cord.
24. Do not shake the appliance by the handle.
25. Do not touch the metal part on the inside of the lid or inner lid during or immediately after operation.
26. Do not operate the appliance near flames or wet areas.
27. Do not operate the appliance on an unstable surface or on any surface that is not resistant to heat.
28. Do not touch the Lid Release button while carrying the appliance.
29. Do not use any Inner Pot other than provided.
30. Do not place the appliance near walls or furniture (within 12"/30cm).

- 31. Do not place the appliance in the locations where hot cooking oil may splash onto the appliance or where the appliance is exposed to direct sunlight.
- 32. Do not place a cloth or towels over the appliance during operation.
- 33. Remove all foreign substances before using appliances.

Special Cord Set Instructions

- A A short power-supply cord is provided to reduce risks of becoming entangled in or tripping over a longer cord.
- B Extension cords are available and may be used if care is exercised in their use.
- C If extension cord is used:
 - (1) The marked electrical rating of the extension cord should be at least as great as the electrical rating of the appliance.
 - (2) The longer cord should be arranged so that it will not drape over the counter-top or table top where it can be pulled on by children or tripped over.

Do not damage the power cord.

Do not process, forcibly bend, pull by force, twist or bind the power cord.

Do not place heavy objects on the power cord, or apply too much force to it.

Do not damage the power cord while moving the unit.
(Otherwise, fire or electric shock may be caused.)

Do not plug/unplug the power cord with wet hands.
(Otherwise, electric shock may be caused.)

Do not connect the unit from extension cord or multiple wiring with other electronic appliances.
(Otherwise, electric shock, fire or heat may be caused.)

Do not use other than the rated voltage (220-240V~).

Do not operate or stop the unit by using the power plug.
(Otherwise, electric shock or fire may be caused.)

Make sure there is no dust on the power plug and insert it into the outlet completely.

Any dust around the power plug should be wiped off with a dry cloth periodically.
(Accumulated dust may result in poor insulation from humidity, etc., thereby causing fire or electric shock.)

Warning



Risk of electric shock.

Only use grounded outlets.

Do not remove the grounding connection.

Do not use any adapters.

Do not use any extension cables.

Failure to observe these instructions may result in lethal injuries, fire or electric shock.

Before first use

Remove the unit from packaging.

HAZARD FOR CHILDREN – risk of death due to choking/swallowing of packaging.

Keep packaging away from children.

Dispose of it immediately.

Disconnect the power plug from the socket.

Clean the container with hot water and a bit of detergent prior to first use. Wipe the pot dry with a cloth.

Do not immerse electrical components under water!

Wipe the lid only with a damp cloth and then let it dry.

PRECAUTION FOR THE COOKER

Do not put fingers or foreign objects (pin, needle, stick, etc.) into the gap of the unit (injury, electric shock and malfunction may occur).

Do not put rices or foreign objects into the gap of the key lock and the temperature sensor (malfunction and fire may occur).

Do not make modifications. Disassembly, repairing, modifications shall not be made by a person other than the service engineer.
(Otherwise, fire, electric shock or injury may be caused.)

Do not place spray cans close to the main unit.

Do not use flammable hazardous materials (gasoline, thinner, etc.) near the main unit (otherwise, ignition of fire, explosion may occur).

Do not substitute the inner pot with other container.
(Otherwise, higher temperature and burning injuries may occur.)

Do not place the unit near heating appliances.
(Otherwise, plastic parts will melt and fire ignition may occur.)

In case of an exception (e.g., burnt smell).
Be sure to immediately shut down the product, remove its power plug and contact customer service center for repair.
(Otherwise, electric shock or fire may be caused.)

For repairs, please consult the nearest customer service center.

Before Maintenance

Be sure to allow the unit cool off and remove its power plug.
(Otherwise, electric shock or injury may be caused.)

Power Plug, Power Cord

Always hold the power plug, when unplugging the unit.
(Otherwise, fire, electric shock, short circuit may be caused.)

If you are planning not to use the unit for a long time, unplug the power plug from outlet for safety.
(Otherwise, electric shock, electric leakage or fire may be caused.)

During Usage

Do not knock down or drop the main unit.

Do not store or move with the main unit down on its side.

(Otherwise, equipment damage or malfunction such as water/electric leakage may be caused.)

Do not use the unit in a tight enclosed space such as closet or in between furniture.

Do not cover the unit with cloth during use.

(Otherwise, malfunction, deformation and color changed may occur.)

Do not wash the product directly with water.

For indoor use only. Do not use the unit under direct sunlight or in any location exposed to rain and wind.

Do not use the product in a place where it can easily get wet or in the bathroom.

Do not leave the unit where oil or flammable gas may leak.

(Otherwise, electric shock, over-heating, electric leakage or fire may be caused.)

Operate the unit only on level, stable surfaces.

(Otherwise, malfunction and fire may occur.)

Do not sit on or lean on to the product.

(Otherwise, injury may be caused from moving or falling.)

Look out when the following type of people is in the room.

(Baby, children, elderly person who cannot operate this product.)

This appliance is not intended for use by persons (include children) with reduced physical, sensory or mental capabilities or lack of experience and knowledge, unless they have been given supervision or instruction concerning use of the appliance by a person responsible for their safety.

Children should be supervised to ensure that they do not play with the appliance.

Operate the unit only on level, stable surfaces.

Be sure to clean the product, floor and surroundings when using the production a same place for a long period of time.

Cleaning and user maintenance shall not be made by children without supervision.

If there is a noise in TV/radio or radio clock does not display the correct time, move the product away as far as possible.

(Otherwise, radio disturbance may be caused.)

Always have plenty of room around the main unit.

(Poor ventilation may cause over-heating, fire, malfunction.)

1) This appliance is intended to be used in household and similar applications such as:

- staff kitchen areas in shops, offices and other working environments;
- farm houses;
- by clients in hotels, motels and other residential type environments;
- bed and breakfast type environments.

2) The instructions for all appliances shall include:

- avoid spillage on the connector;
- after use, the heating element surface is subject to residual heat.

Don't heat inner pot on others (e.g., induction cooker, gas stove).

Don't insert anything into the vent.

Avoid of scalded by steam out of the vent, specially children.

Don't cook food types easy to block the vent (e.g., Seaweed, kelp, etc).

Don't cover the vent avoid steam can't be released.

Don't keep warm long time avoid of affecting the rice taste.

Please operate legally according to the user manual, while it will be possible to cause fire, electric shock or body injury.

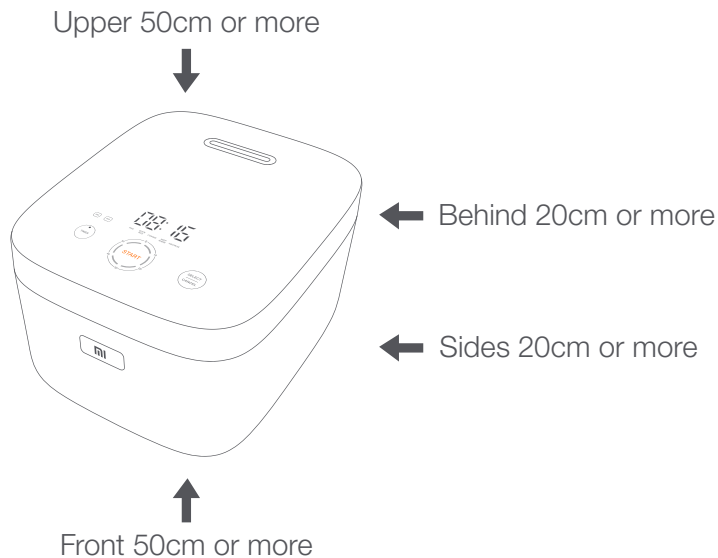

Product Overview

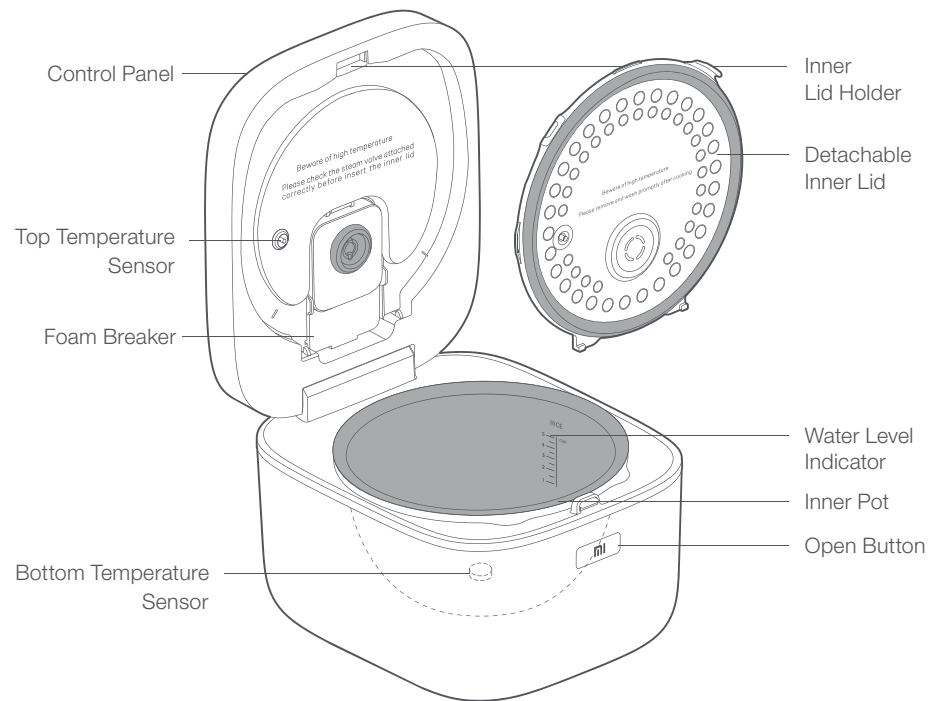

Control Panel

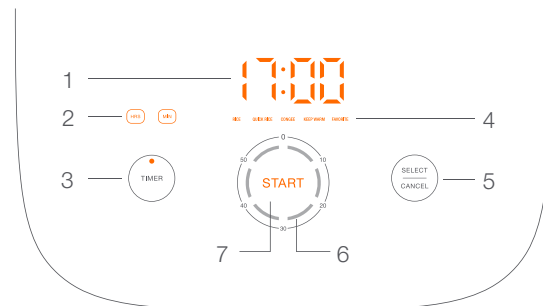

Accessories



Rice Paddlex1



Congee Paddlex1



Measuring Cupx1



Steamerx1



Power Cordx1

Quick Start Guide

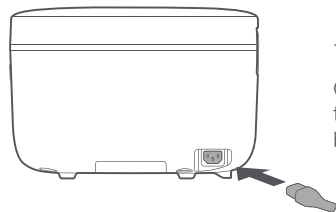

1. Connect to power supply

Connect one end of the power cord to the power port on the base of the main body, the other end to a power supply.



2. Connect to Wi-Fi

The product will stand by for Wi-Fi connection when powered on for the first time. Please go to Mi Home app for connection and setting.

Note: Insert a straightened tool into the Wi-Fi Reset hole for 5 seconds to restore stand-by status.



Wi-Fi Indicator Status

To be connected	Connecting	Connected
Blinking orange	Blinking blue	Solid blue

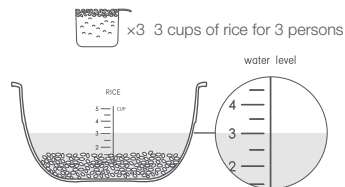

3. Add rice and water

When cooking 3 cups of rice, add water to water level 3. Adjust the amount of water accordingly to prevent overflowing and short-circuit.

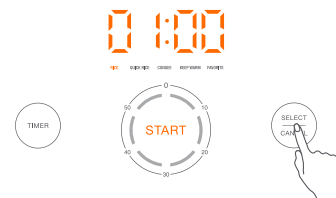

4. Set the menu

After the rice cooker's powered on, press "Select/Cancel" button, and select "Rice" for 60 minutes of fine cooking and "Quick Rice" for 40 minutes of quick cooking.

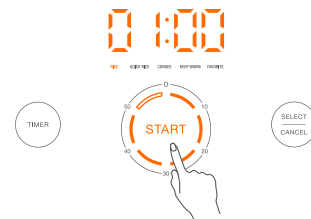

5. How to cook rice

Press "Start" to start cooking rice. LED Display indicates time, and 50-0 section is breathing, with the other five sections solid.

Note: "Rice" and "Quick Rice" modes are for rice cooking only. Cooking food other than rice may compromise the rice cooker's performance.

Download the APP

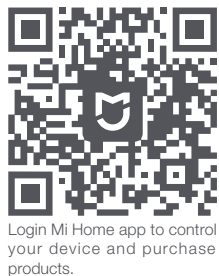

Download the App and add devices

Scan the QR code or go to app store to download Mi Home app.

Open Mi Home app, and add "Mi Induction Heating Rice Cooker" in "My devices", and the device will display on your device list.

Once connected to Mi Home app, the product can be remotely controlled and interact with other Mi products.

How to Set the Time

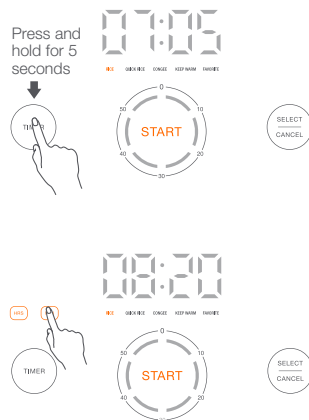

- 1 Press and hold "Timer" button for 5 seconds to enter time setting mode.

Note: When connected to Wi-Fi, the time will sync automatically.

- 2 Press "HRS" and "MIN" buttons to set the time, and click the "Start" button to confirm.

Control Panel Description

1. LED Clock

Function	Status	Display
Rice	Counting down	Remaining cooking time
Quick rice	Counting down	Remaining cooking time
Congee	Counting down	Cooking completion time
Keep warm	Counting	Keep warm time
Favorite	Counting down	Remaining cooking time
Timer	—	Cooking completion
Stand by	—	Current time

2. Countdown indicator

The six sections of breathing light indicate 0 to 60 minutes, with one section as 10 minutes.

Function	Status	Display
	50-60 minutes	50-0 section is breathing, with the other five sections solid
	40-50 minutes	40-50 section is breathing, with the other four sections solid
	More than 1 hour	Six sections solid
	Keep warm	Six sections breathing

How to Cook Rice



Switch Modes

Press the "Select/Cancel" button to select a desired cooking mode. Each press advances in the following order: "Rice, Quick Rice, Congee, Keep Warm, Favorite".



1. Rice

Rice is set as the default mode. Cooking time varies according to rice quantity (the default cooking time is one hour).



2. Quick Rice

Cooking time varies according to rice quantity (the default cooking time is 40 minutes).



3. Congee

The default cooking time is 90 minutes. Time setting for cooking congee. Press "HRS" and "MIN" buttons to set the cooking time between 40 minutes and 4 hours.

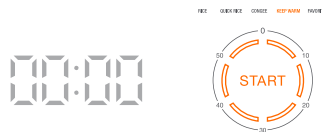

4. Keep Warm

When cooking completes, the rice cooker will automatically keep warm at around 73°C. You can manually select the "Keep Warm" mode.

Note 1: Recommended keep warm time is within 12 hours. After 24 hours, the rice cooker will enter stand-by mode automatically.

Note 2: "Keep Warm" mode can be set by the cellphone after cooking is completed.

Note 3: Part of functions do not switch to "Keep Warm" mode after cooking is completed.



5. Favorite

For further cooking options, please go to the Mi Home app to select your favorite.

Note : At the time of ex-factory, the "Favorite" mode is the "Cake Cooking" by default.

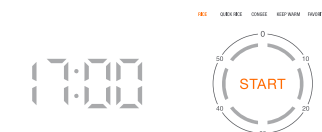

6. Timer

1 Before setting the timer, make sure that the current time is correct. Select a cooking mode (take "Rice" for example), and press the "Timer" button to set the timer.

Note : Presetting is not successful unless the duration from the current time to the preset time is longer than the cooking period; otherwise, the cooking will start immediately.



2 Press "HRS" and "MIN" buttons to set the timer, and click the "Start" button to confirm.

Note: The clock employs 24-hour system for setting.

Cleaning

1. Remove

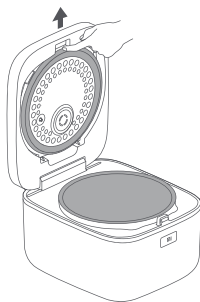

1. Push up the inner lid holder to detach the inner lid.

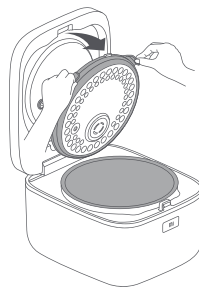

2. Hold the side handle with both hands to remove the inner lid.

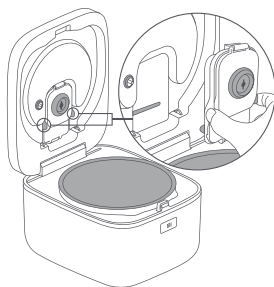

3. The foam breaker reveals when the inner lid is removed. Hold the side handle to detach the foam breaker.

Note: Wash the inner lid and foam breaker after every use.

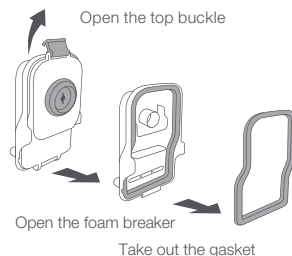

4. Open the top buckle and take out the gasket.

2. Mount

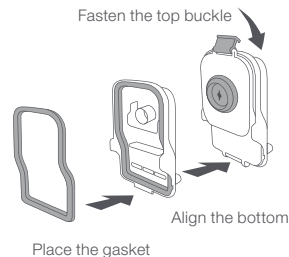

1. Press the gasket into the groove on the foam breaker and align the bottom to properly fasten the top buckle.

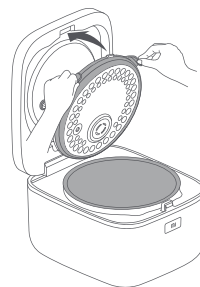

3. Insert the inner lid's supporting ring into the slot, and close the inner lid until you hear it click into place.

Note: The foam breaker and inner lid have to be properly mounted for the lid to close.

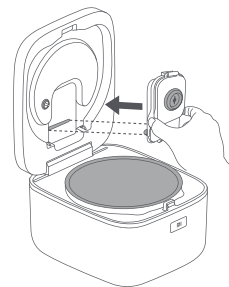

2. Align the foam breaker with the mounting position, and slowly press the foam breaker back in place.

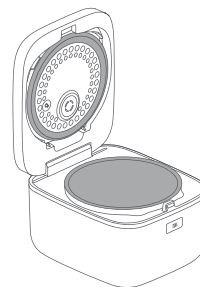

4. The mounting completes when the inner lid is reattached.

Troubleshooting

Problems	Causes and solutions	Problems	Causes and solutions
The outer lid won't close	Check if the inner lid is properly mounted.		Check if the foam breaker or the inner lid set is not thoroughly cleaned since last cooking.
The buttons do not respond	Check if the rice cooker is in "Rice, Quick Rice, Timer" or "Keep Warm" mode, and press "Cancel" to exit.		
Steam comes out	Check if the inner lid gasket is aged, deformed or damaged.	Has abnormal odor while cooking	Check the foam breaker seal ring and inner lid seal ring for abnormal odor.
Rice half-cooked	Water may not be enough.	Rice is scorched on the bottom	Rice may not have been cleaned sufficiently.
	Check if rice is stored for longer than six months.		Check if the bottom of the inner pot is deformed.
	Check if there's any foreign matter stuck to the bottom pot or on the top sensor.		Check if there's any foreign matter stuck to the bottom pot or on the top sensor.
	Check if the aluminum surface of the bottom sensor is deformed.		Check if the aluminum surface of the bottom sensor is deformed.
Boils over while cooking	Check if the bottom of the inner pot is deformed.	During "Keep Warm", rice has an odor and becomes dry	Check if there's any foreign matter stuck to the bottom pot or on the top sensor.
	May have added too much water.		Check if the bottom of the inner pot is deformed.
	Check if there's any foreign matter stuck to the bottom pot or on the top sensor.		Check if the "Keep Warm" mode is used for more than 12 hours.
	Check if the aluminum surface of the bottom sensor is deformed.		Check if the aluminum surface of the bottom sensor is deformed.
Rice cooks too soft	Check if the bottom of the inner pot is deformed.	Firmware upgrade failure	Make sure your rice cooker is not cooking.
	May have added too much water.		Check if the Wi-Fi is working properly.
	Check if the keep warm time exceeds 12 hours.		

Problems	Causes and solutions	Problems	Causes and solutions
Wi-Fi connection failure	Check if your Mi Home app has the latest version.	The "Timer" does not function properly	Check if the "Timer" set exceeds default cooking time.
	Make sure you Wi-Fi signal is strong and stable.		Make sure you press "Start" when you set the timer.
Cooker crashed after up-grading firmware	Unplug your rice cooker and press "Timer" to restore factory settings.		Check if the Wi-Fi is working properly.
			Check if the time shown on the rice cooker is correct.

Fault Code

Error display: the LED display shows the error prompts, with other indicators turned off.

Code	Error description	Notes
E-01	Unlid timeout alarm	During "keep warm" after cooking completed, if the outer lid opens for more than 3 minutes and 45 seconds, there'll be a error display on the control panel. And the cooker enters standby mode when the time exceeds 4 minutes.
E-02	The inner pot is not placed back in place in 30s	Press Cancel to enter standby mode.
E-03	High-voltage protection	Restores when the voltage drops. Press "Cancel" to enter standby mode.
E-04	Low-voltage protection	Restores when the voltage raises. Press "Cancel" to enter standby mode.
E-05	Bottom high temperature alarm	Bottom temperature is high and error is reported. So press "Cancel" to enter the standby mode.

Code	Error description	Notes
E-06	Upper lid temperature is high and error is reported	So press "Cancel" to enter the standby mode.
E-07	IGBT sensor temperature is high and error is reported	So press "Cancel" to enter the standby mode. (Recover when IGBT temperature returns to normal.)
E-08	IGBT sensor damage (including short circuit and open circuit)	Non-recoverable
E-09	Top sensor damage (including short circuit and open circuit)	Non-recoverable
E-10	Bottom sensor damage (including short circuit and open circuit)	Non-recoverable
E-11	Communication error	The display panel and power board subject to the communication line failure and error is reported. So press "Cancel" to enter the standby mode.
E-12	Power circuit failure	Non-recoverable

Specification

Product name	IH Rice Cooker		Model	IHFB01CM	Capacity	1.0L
Heating method	Induction heating		Material of inner pot	Alloy	Rated power	220-240V~/50-60Hz
Gross weight	5.8kg		Net weight	4.4kg	Product dimension	300×215×200mm
Frequency band	2412-2472MHz	Wireless Connections	Wi-Fi IEEE 802.11b/g/n 2.4GHz		The maximum RF Power	17.80dBm

DOC

Shanghai Chunmi Electronics Technology Co.,Ltd declares that this IHFB01CM is in compliance with the essential requirements and other relevant provisions of Directive 2014/53/EU.

Importer:
Beryko s.r.o.
Na Roudné 1162/76, 301 00 Plzeň
www.beryko.cz



Disposal

Products with this symbol are recyclable, please separate from your household waste when disposing. Proper handling can protect the environment and benefit human health. Your local government or retailer can provide further information about the matter.

Manufacturer: Shanghai Chunmi Electronics Technology Co.,Ltd.

Address: Room 01-04,1/F, No.2 Building, No.60, Naxian Road, Pilot Free Trade Zone, Shanghai, China.

物料条码黏贴处